

Porter Creek Water Reservoir in Whitehorse, YK

Description: Buried 4000 cubic meter capacity reinforced concrete water reservoir, 16 sided in plan and 6.5 m height, complete with roof hatch, ladder and other mechanical features.

Principal Client: City of Whitehorse

Prime Consultant: OPUS DaytonKnight Ltd

Prime Consultant Contact: Ms. Carol Campbell, P.Eng.

Key Personnel: *Kam Soltani, P. Eng.,*

Duties: *Structural design*



Selkirk Pump Station in Whitehorse, YK

Description: 5000 square feet Pumping station involving pump room, control room, mechanical room, generator room/ 400 KW Genset, Chlorine generation room and workshop. Monorail, pump foundations and trenches as well as other mechanical/dynamic foundations outside the building are other features of this building.

Principal Client: City of Whitehorse

Prime Consultant: OPUS DaytonKnight Ltd

Prime Consultant Contact: Ms. Carol Campbell, P.Eng.

Key Personnel: *Kam Soltani, P. Eng.,*

Duties: *Structural design*



Coquitlam Centre Pump Station

Description: Sewage pumping station involving influent sewer, diversion chambers, FRP wetwell, valve chambers, forcemain and control building. The control building is composed of masonry block, glulam beams. The building will house a new 200kw generator, motor control centre, odour control system and a washroom.

Principal Client: City of Burnaby

Prime Consultant: OPUS DaytonKnight Ltd

Prime Consultant Contact: Mr. David Roulston, P.Eng.

Key Personnel: *Kam Soltani, P. Eng.,*

Duties: *Structural design*





Duncan Water Intake & Genset Foundation

Description: Water intake and Genset foundation.

Principal Client: City of Duncan, BC

Prime Consultant: OPUS DaytonKnight Ltd

Prime Consultant Contact: Ms. Bengul Kurtar, P.Eng.

Key Personnel: *Kam Soltani, P. Eng.,*

Duties: *Structural design*





Ladysmith WWTP Dewatering Centrifuge Installation

Description: Dewatering centrifuge structural support and pump pad/cover structure.

Principal Client: Town of Ladysmith, BC

Prime Consultant: OPUS DaytonKnight Ltd

Prime Consultant Contact: Ms. Bengul Kurtar, P.Eng.

Key Personnel: *Kam Soltani, P. Eng.,*

Duties: *Structural design*



Wastewater treatment, Golden



Description: Structural design of Sequencing Batch Reactor in Wastewater treatment facilities of Town of Golden in BC.

Project designed by Urban Systems Ltd., Winner of APEGBC 2005 awards of Engineering Excellence.

Photos: Aerial view of facilities, Schematic of similar facility.

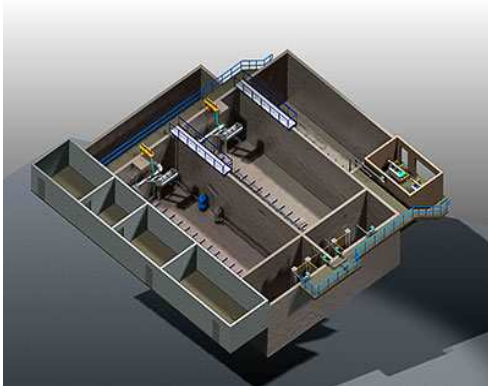

Principal Client: Urban Systems Ltd.

Client Contact: Mr. Chris town, P.Eng.

Key Personnel: Kam Soltani, P. Eng.,

Duties: Structural design of heavy reinforced concrete reservoirs ad light operation building

Structural Design & Detailing, Earth Dam/ Concrete Membrane, in Kotmale, Sri Lanka.

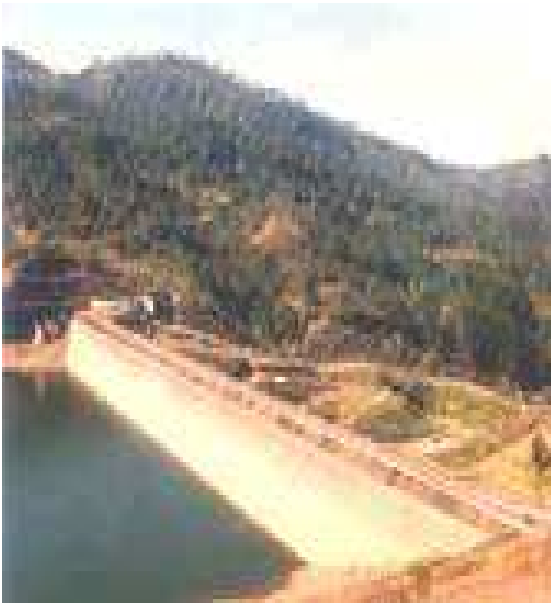

Description: Structural design of Dam Membrane, Plinth, Diversion Tunnel outfall structures, Spillway Location & design. Hydro Electric Dam Project in Kotmale, Sri Lanka.

Dam crest length 1000m, base width 800m & water height 110m.

Principal Client: Government of Sri Lanka.

Client Contact: Eng. Mr. Pathiwila – Project Manager.

Key Personnel: *Eng. Ranji Casinader, Eng. Ron Wyburn & Mohamed Luthfy, Chartered Engineer.*

Duties: Structural design of various components & detail drawings for construction.

Structural Design, Detailing & Supervision. Salinity Barrier, Greater Galle Water Supply Project, Galle, Sri Lanka.



Description: Structural design of Salinity Barrier Structure, Greater Galle Water Supply Project in Galle, Sri Lanka.

Dam crest length 120m, Five Gated Structure for Flood Control.

Principal Client: Water Supply Authority of Sri Lanka.

Client Contact: Eng. Mr. Karunaratne – Project Manager.

Key Personnel: *Mohamed Luthfy, Chartered Engineer.*

Duties: Complete Structural Design of all the components & Detail drawings for construction.



Structural Design, Detailing & Supervision. Intake Structure, Greater Galle Water Supply Project, Galle, Sri Lanka.



Description: Structural design of Intake Structure, Greater Galle Water Supply Project in Galle, Sri Lanka.

Capacity of Intake: 100,000 m³/day.

Principal Client: Water Supply Authority of Sri Lanka.

Client Contact: Eng. Mr. Karunaratne – Project Manager.

Key Personnel: *Mohamed Luthfy, Chartered Engineer*

Duties: Complete Structural Design of all the components & Detail drawings for construction.



Structural design, Detailing & Supervision. Ground Reservoir & Pump House, Greater Galle Water Supply Project, Galle, Sri Lanka.



Description: Structural design of Ground Reservoir & Pump House, Greater Galle Water Supply Project in Galle, Sri Lanka.

Ground Reservoir Capacity: 12,000 m³.

Principal Client: Water Supply Authority of Sri Lanka.

Client Contact: Eng. Mr. Karunaratne – Project Manager.

Key Personnel: *Mohamed Luthfy, Chartered Engineer.*

Duties: Complete Structural Design of all the components & Detail drawings for construction.

